

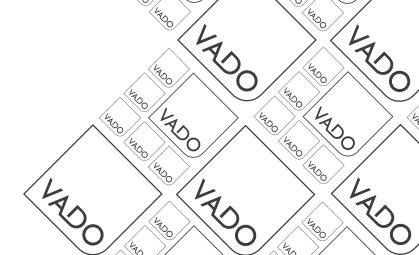

where inspiration flows

# OMIKA

Installation Guide  
Floor Mounted Bath Shower Mixer



This instruction booklet covers model:  
OMI-133-C/P

OMI-133-C/P

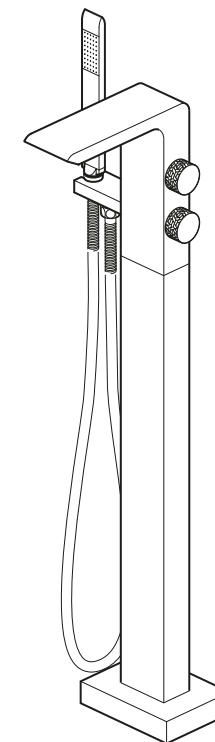

Vado  
Wedmore Road, Cheddar, Somerset, England BS27 3EB  
tel 01934 744466. fax 01934 744345  
aftersales@vado.com  
www.vado.com



# Contents

Important information.....	3
General installation.....	3
Operating Specifications .....	3
Contents of packaging .....	4
Dimensions.....	5
Installation - Quick guide.....	6
Installation.....	8
Installation - Shower.....	11

## Important - please read

Please read these instructions carefully before starting installation and keep for future reference.

Remove all packaging and check the product for missing parts or damage before starting installation.

Any alterations made to this product and fittings may infringe water regulations and will invalidate the guarantee.

The installation must comply with all Local/National Water Supply Authority Regulations/Byelaws and Building and Plumbing Regulations.

To be installed in accordance with BS EN806.

We strongly recommend that you use a qualified and registered plumber.

## General installation

This fitting is a mixing device and therefore water supplies should be reasonably balanced. It is strongly recommended that non-return valves (NRVs) are fitted on both hot and cold supplies.

When installed, the fitting must comply with the requirements of the Water Supply (Water Fittings) Regulations 1999 and Scottish Byelaws 2004.

For further information, contact the Water Regulations department of your local water supplier (see the WRAS website [www.wras.co.uk](http://www.wras.co.uk) for details) or the Water Regulations Advisory Scheme by email ([info@wras.co.uk](mailto:info@wras.co.uk)) or telephone: 01495848454.

Before making any inlet pipe connections, all supply pipes MUST be thoroughly flushed to remove debris. Failure to do so could result in damage or low flow from the mixer unit.

The fitting of isolating valves to the inlet feeds is advised for ease of maintenance.

Please take great care when installing this mixer not to damage its surface.

Please note if installing in an enclosed environment, access should be left for servicing and maintenance. No costs relating to inadequate access can be accepted.

## Operating Specifications

### Operating Pressure

**Minimum operating pressure** 1 bar

**Maximum operating pressure** 5 bar

# Contents of Packaging

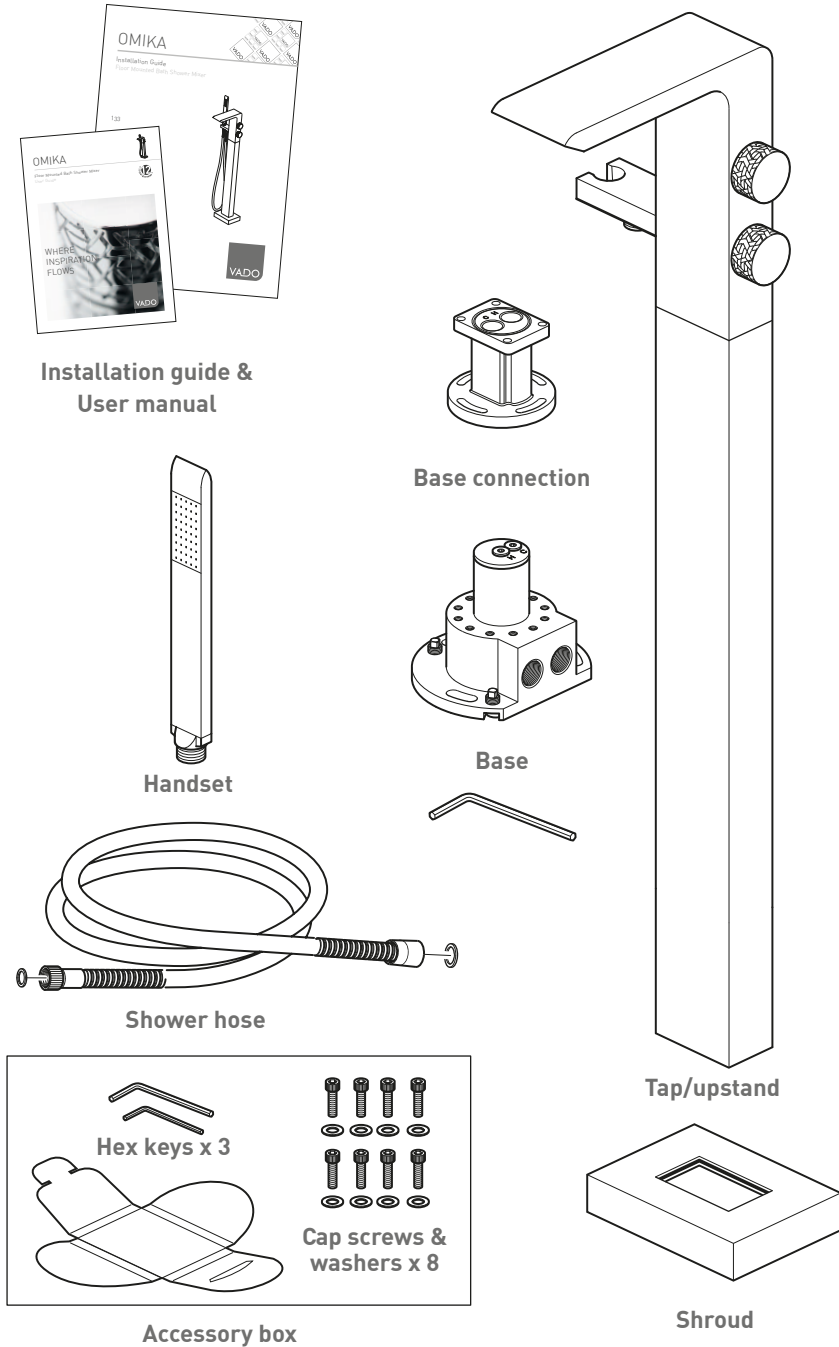

# Valve dimensions

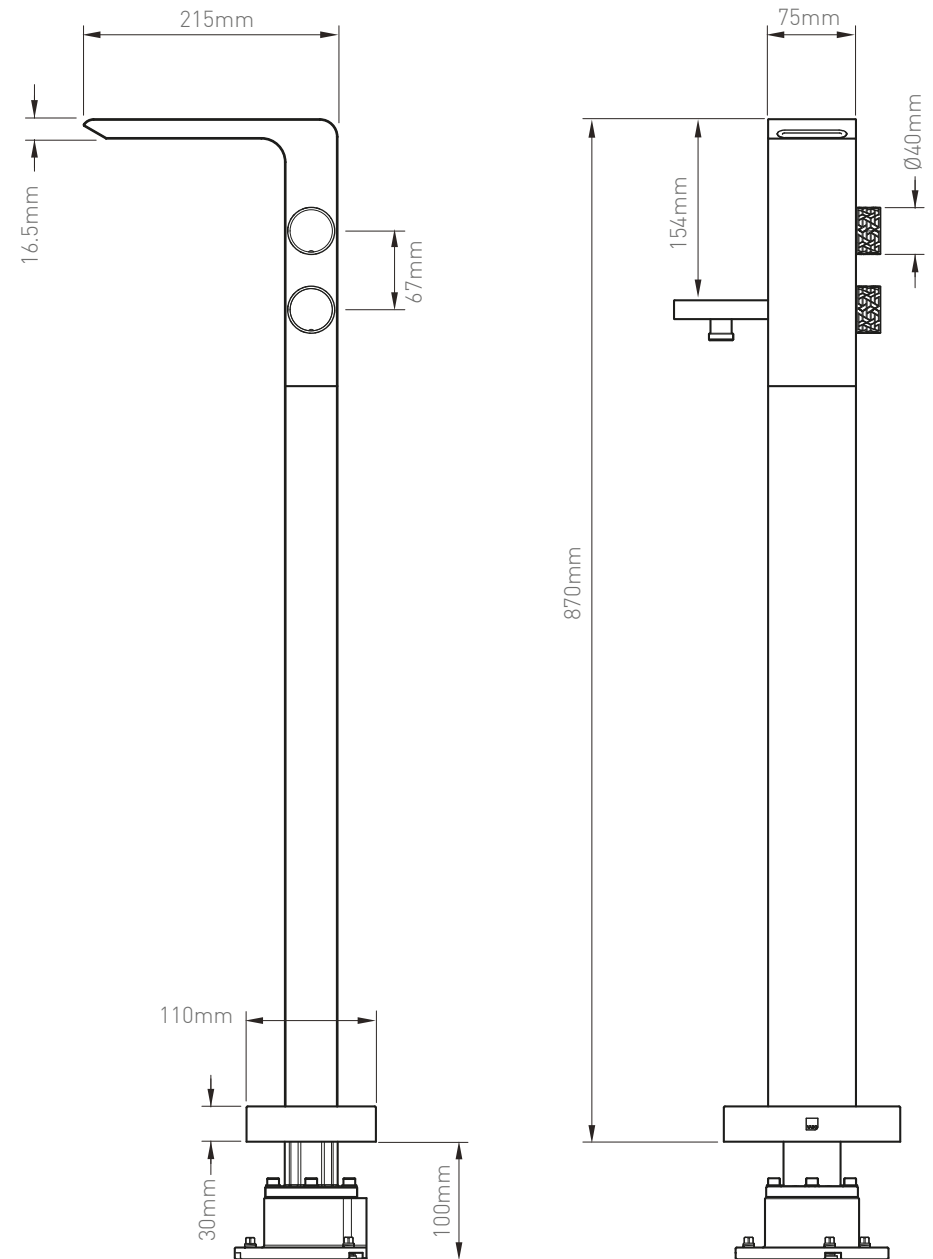

# Installation - Quick guide

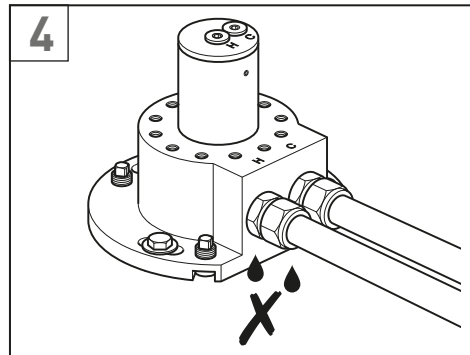
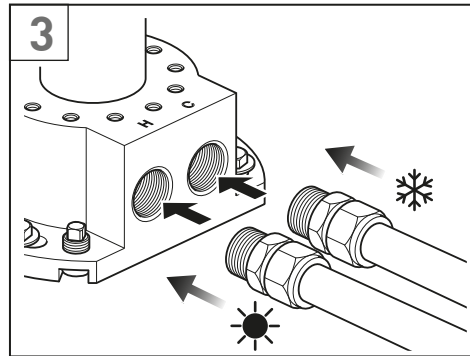
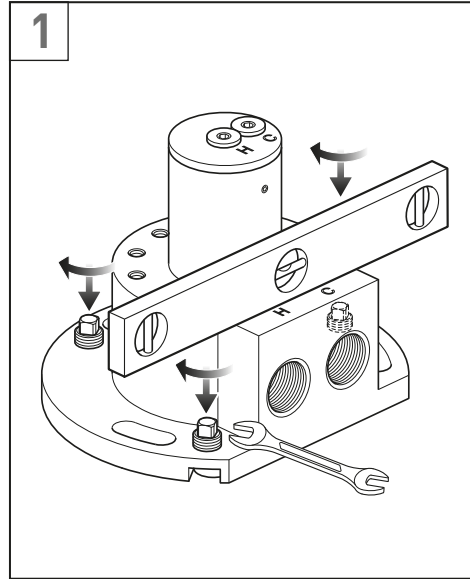
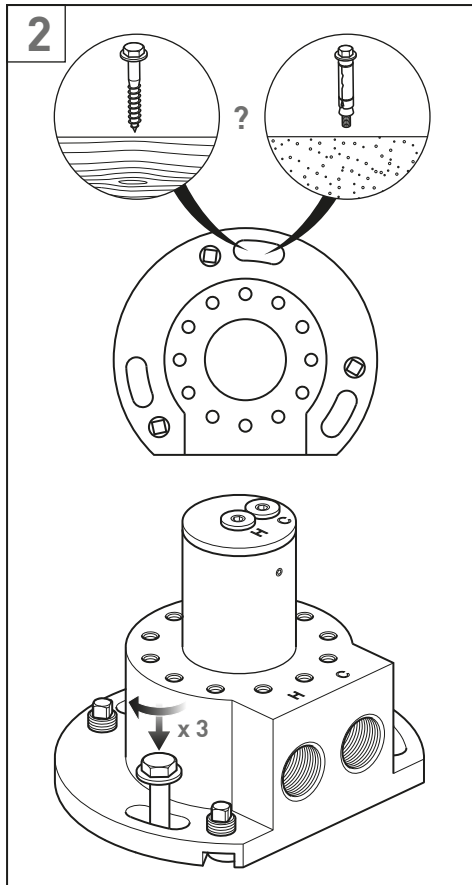
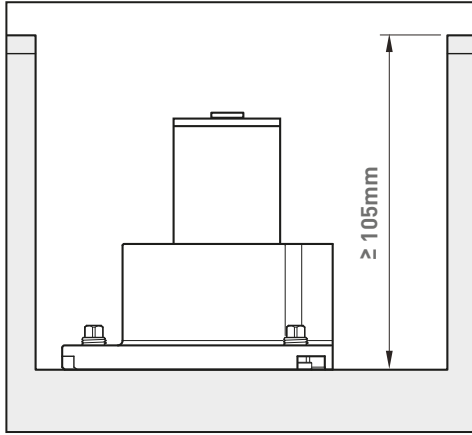

# Installation - Quick guide

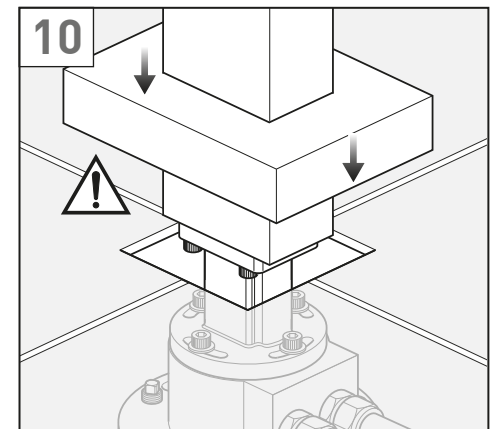
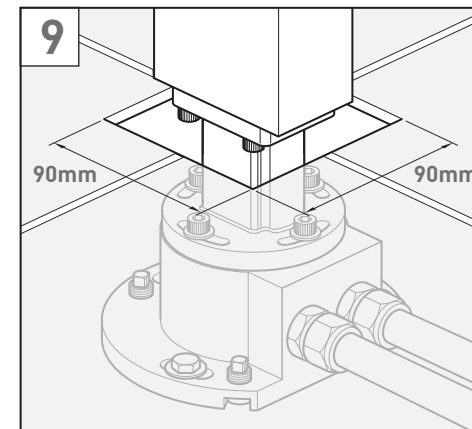
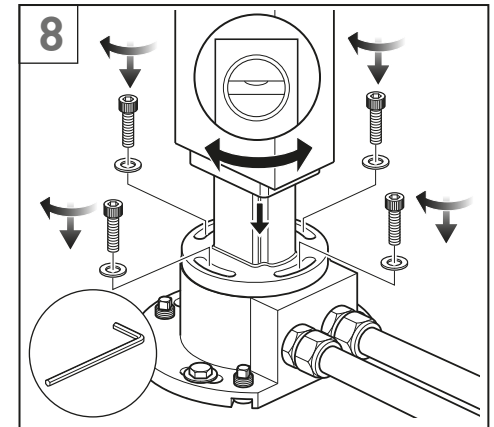
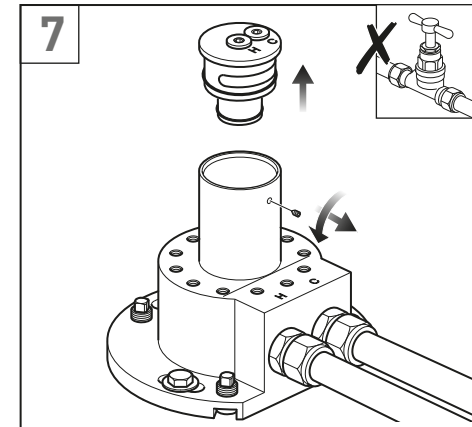
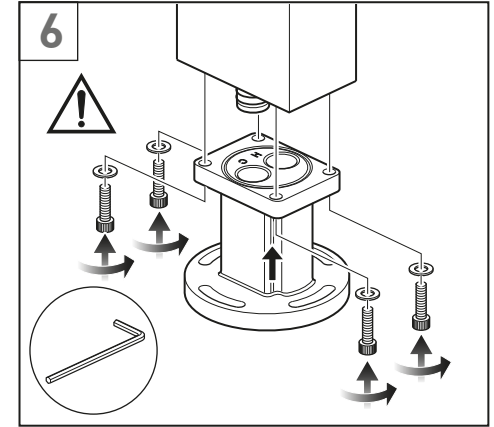
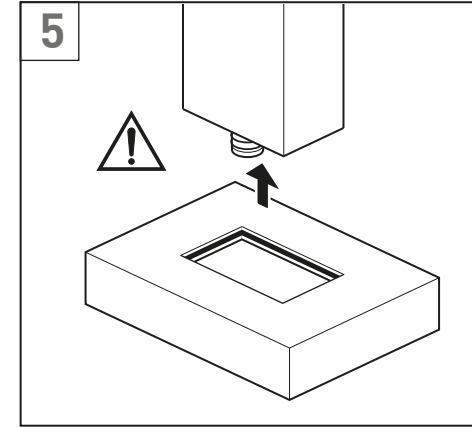

# Installation

**Warning!** Please check for any hidden cables and pipes before drilling holes.

The base must be recessed below the final floor level by at least 105mm.

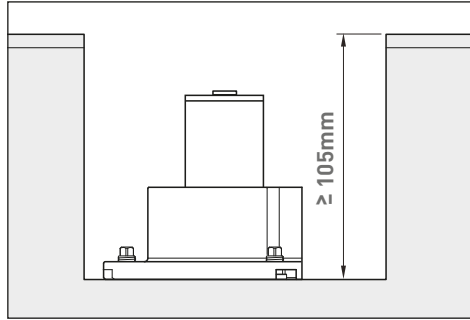

There are 3 fixing positions and 3 levelling bolts.

Use suitable fixings (not supplied) for your substrate e.g. expansion bolts for concrete, or coach screws for wood.

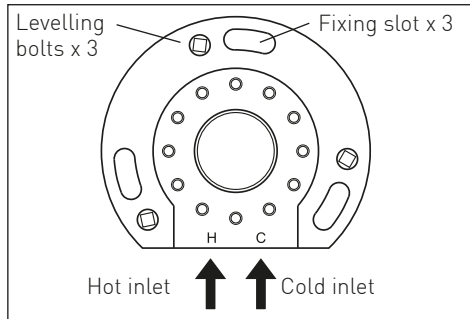

Position the base in the desired location, mark the 3 fixing holes. Remove the base and drill the 3 x holes to the required diameter and depth to suit your fixings.

Fit the base in position, but do not tighten. Use the adjusting screws to level the seat, when satisfied with the level, finally tighten the fixings.

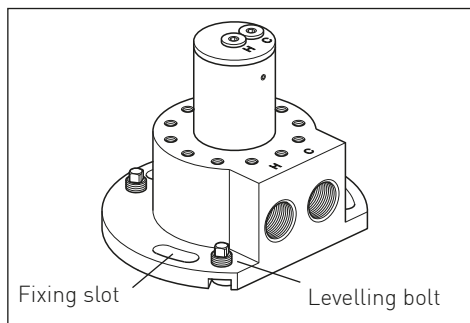

Connect the hot and cold supplies to the base. The hot should be fixed to the outlet marked **H** and the cold fixed to **C**.

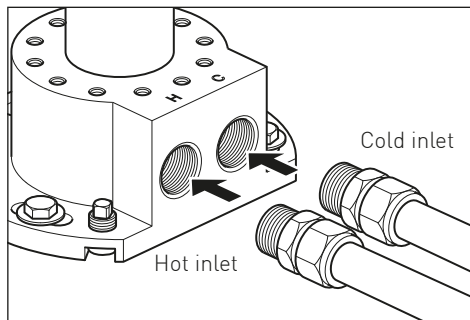

# Installation

Turn on the water and check for any leaks in the pipe work.

Turn off the water supply.

Remove the grub screw and pull the drain valve out of the base.

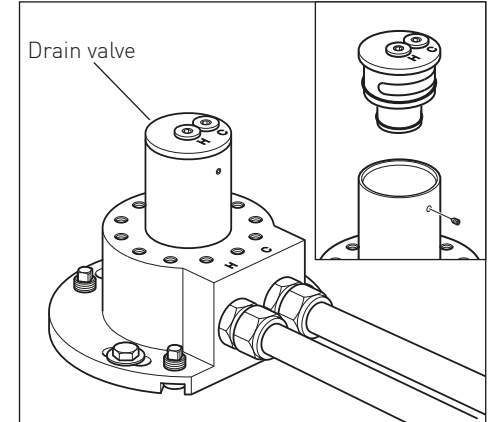

Slide the shroud onto base of upstand.

To ensure smooth movement of shroud and prevent scratching during installation, please use a suitable silicone based lubricant.

**Warning!** Be sure to keep the shroud level, and raise both sides equally.

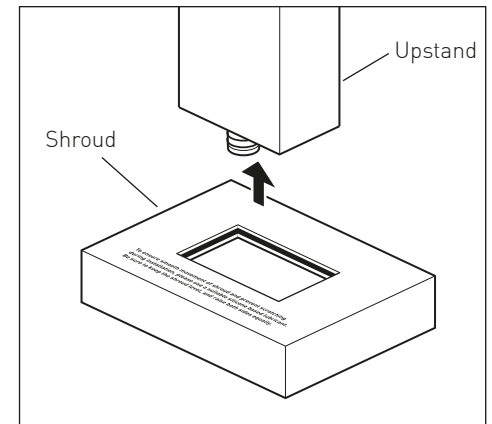

Using the 4 supplied cap screws and washers secure the base connection onto the bottom of the tap/upstand. Ensure the correct tap/upstand pipes are connected to the assigned holes in the base connection - the **H** should be connected to the hot inlet and the **C** should be connected to the cold inlet.

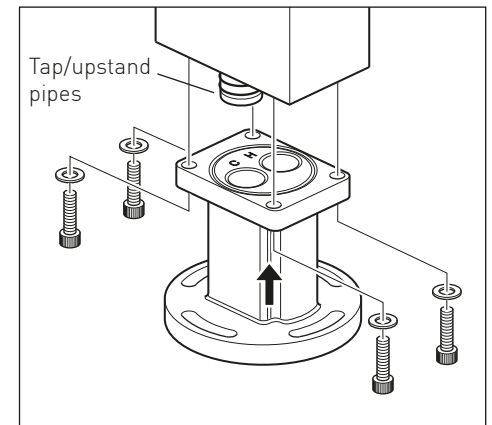

## Installation

Place the base connection onto the base.  
Rotate the tap/upstand until the outlet is in the desired position.

When satisfied, secure using the x 4 supplied cap screws and washers.

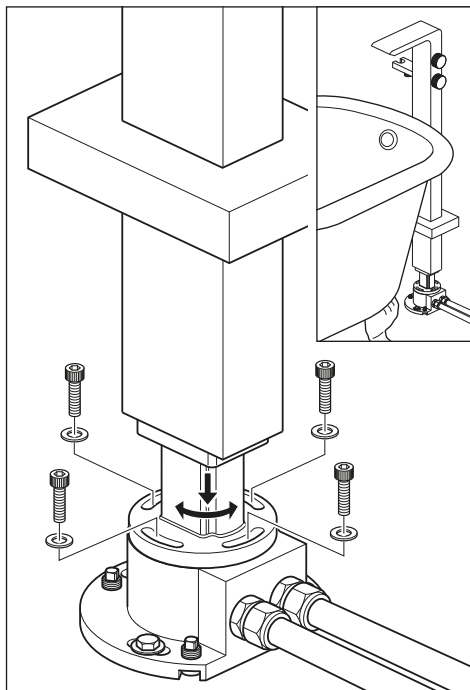

Finish the floor covering down to a dimension of 90mm x 90mm.

Keep the tap/upstand protected while the floor is being completed.

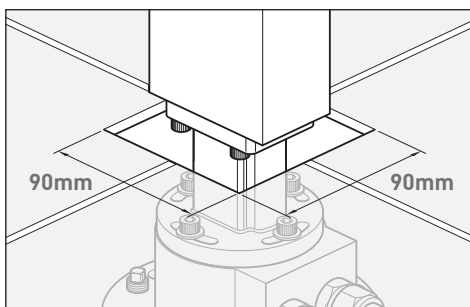

Slide the shroud down until it makes connect with the floor.

⚠ Be sure to keep the shroud level, and lower both sides equally.

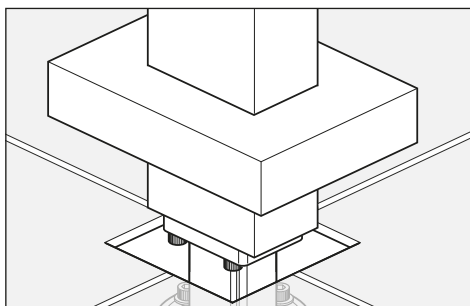

## Installation - shower

### Handset

Place one of the rubber washer into the cone end of the hose and screw to the handset.

Place the cone into the bracket

### Outlet

Place the second rubber washer into the nut end of the hose and attach it to the mixer outlet.

